

**16" STANDARD BLOWER (9515), 16" HIGH OUTPUT BLOWER (9516)
 20" STANDARD BLOWER (9525), 20" HIGH OUTPUT BLOWER (9525-50)
 26" STANDARD BLOWER (9530)**

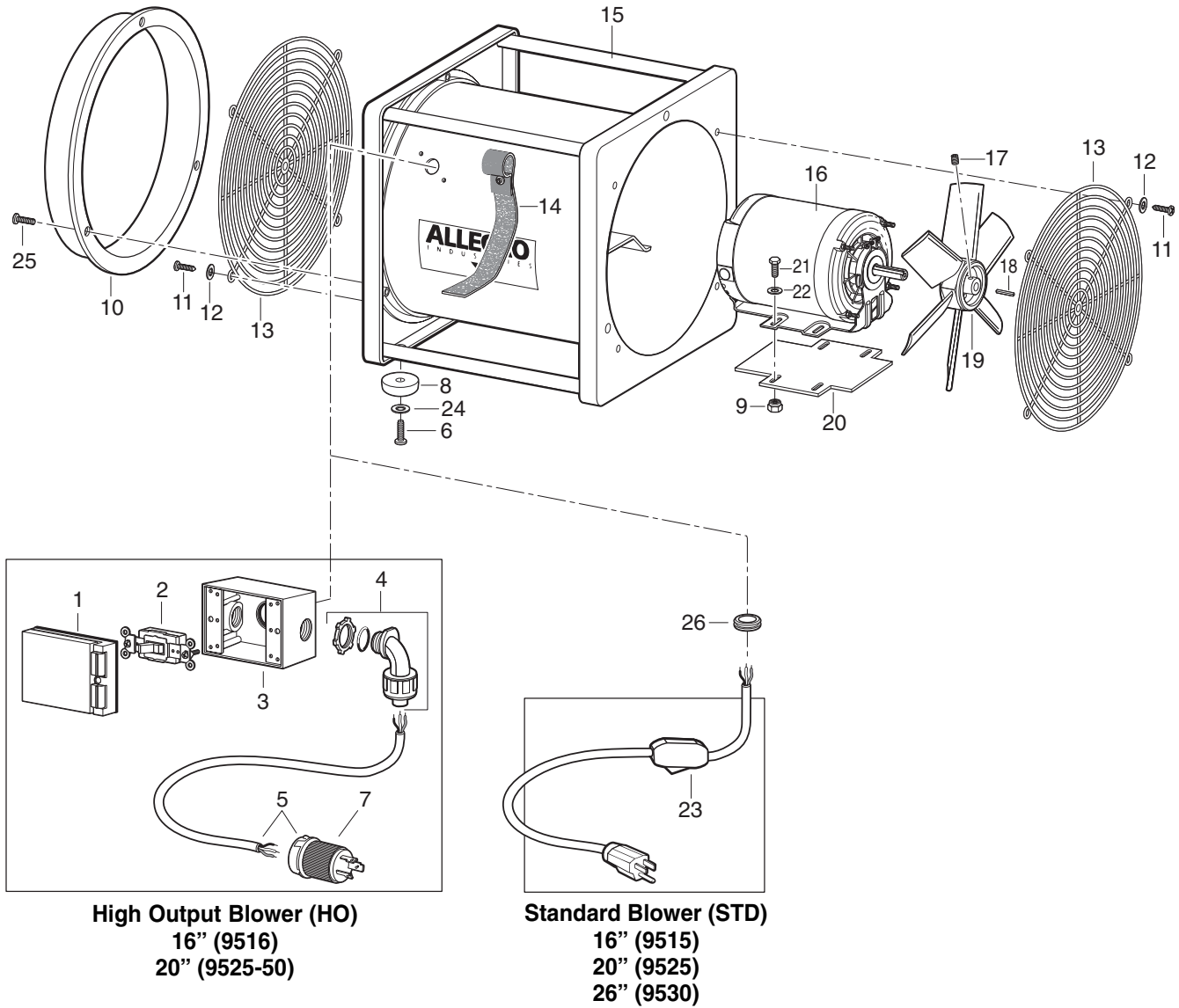

**High Output Blower (HO)
 16" (9516)
 20" (9525-50)**

**Standard Blower (STD)
 16" (9515)
 20" (9525)
 26" (9530)**

Key Part #	Description	Key Part #	Description	Key Part #	Description
9515	16" Standard Blower (STD)	10	9525-03R 20" Metal Duct Ring Adaptor	18	9505-09A Key (For STD only)
9516	16" High Output Blower (HO)		9525-03RP 20" Plastic Duct Ring Adaptor	19	9515-14 Fan, 6 Blade (16" STD)
9525	20" Standard Blower (STD)		9530-03RP 26" Plastic Duct Ring Adaptor		9515-06 Fan, 3 Blade (16" HO)
9525-50	20" High Output Blower (HO)	11	9500-75 Machine Screw		9525-14 Fan, 3 Blade (20" STD)
9530	26" Standard Blower (STD)	12	9513-16 Grommet		9525-06 Fan, 4 Blade (20" HO)
1	9516-09 Switch Cover	13	9515-02 Grill (16" Blower)		9530-06 Fan, 3 Blade (26" STD)
2	9516-08 Switch		9525-02 Grill (20" Blower)	20	9515-04 Motor Mount Pad
3	9516-07 Switch Housing		9530-02 Grill (26" Blower)	21	9500-82 Tap Bolt
4	9503-04 Flex Conduit	14	9515-30 Cord Restraining Handle	22	9800-61 Flat Washer
5	9516-20 Cord w/Plug Assy., 30A/125V (HO)	15	9515-05 Chassis (16" Blower)	23	9515-07 Cord (STD)
6	9800-68 Machine Screw		9525-05 Chassis (20" Blower)		9533-75 Cord (26" STD)
7	9842-74 Plug 115V		9530-05 Chassis (26" Blower)	24	9500-63 Flat Washer
8	9505-06 Feet	16	9515-10 Motor 1/2 H.P. 120V (16" & 20" STD)	25	9800-66 Machine Screw
9	9500-68 K-Nut		9516-04 Motor 2 H.P. 120V (16" & 20" HO)	26	9515-11 Grommet (STD)
10	9515-03R 16" Metal Duct Ring Adaptor		9530-04 Motor 2 H.P. 120V (26" STD)		
	9515-03RP 16" Plastic Duct Ring Adaptor	17	9513-62 Socket Set Screw		